

Supracoating RLV

Ready-to-use liquid bituminous system
for flashings and small points



Ready-to-use cold liquid sealant

Easy to apply

Without primer on dry and clean substrates

Jointless and seamless waterproofing

Several possible finishes

Packaging

- Supracoating RLV:
 - ▶ Indivisible carton of 4 cans of 4 kg
 - ▶ Can of 15 kg
- Parathane Mat:
 - ▶ Roll of 0.50 m x 10 m
 - ▶ Roll of 0.50 m x 50 m
- Flakes or colour pellets:
 - ▶ Bags of 25 kg

Uses

- Supracoating RLV is designed for the treatment of small points and flashings on bituminous seals.
- It is used for new jobs as well as re-roofing.
- It is particularly suitable:
 - ▶ Where torching is forbidden or dangerous (flammable environments, flashings under PVC joinery, skylight frames, etc.);
 - ▶ When the sealing of singular points is difficult to perform (sunken gutters, complex flashings with numerous corners, areas difficult to access, etc.).



Description

Single-component bitumen-polyurethane liquid sealing system made up of two Supracoating RLV coats and a Parathane Mat brace. Total consumption: 1.6 kg/m² (first coat 900 g/m², second coat 700 g/m²)

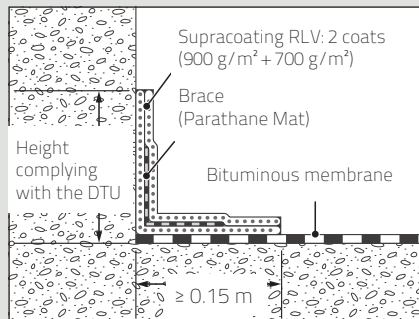

In some cases (see CCP), the use of Supracoating RLV enables the elimination of water drainage systems. Supracoating RLV withstands thermal shocks caused by asphalt casting.

Application

Supracoating is applied with a brush or roller after sealing the intermediate sections. In all cases, the substrate must be sound, clean, dry and cohesive.

Permissible substrates:

- Bituminous sealant;
- Masonry complying with DTU 20.12;
- Metal skylight frame complying with DTU 43.3;
- Wood-based panels complying with DTU 43.4;
- Fibrous perlite;
- Cellular glass.

Preparatory work:

- Removing non-adherent granules or flakes on mineral self-protection;
- Trimming metal foil on metallic self-protection;
- Brushing and sweeping non-adherent sand on vitrified finish;
- Removing plastic films.

Treating the flashing:

- Apply the first coat of Supracoating RLV at the rate of 900 g/m² (photos 1 and 2);
- In the corners, apply a Parathane Mat strip in the first coat that is still fresh watching out for possible air bubbles (photos 3 and 4);
- After drying (3 to 6h depending on atmospheric conditions), apply the second coat of Supracoating RLV at the rate of 700 g/m² (photo 5);
- The flashing may remain as is or receive mineral granules of the same colour as the sealant of the intermediate sections (photo 6).

Reference documents

CCP Supracoating RLV.

Safety

This product is classified as hazardous in accordance with the EC regulations no. 1272/2008 (relating to the classification, labelling and packaging of substances and mixtures). The safety data sheets (FDS) of our products may be freely downloaded from the website www.siplast.fr ("Safety Data Sheets" tab). The applicator must have the latest version so that he is aware of the risks and precautions to be taken.

This document is only indicative, it is recommended to consult the reference documents in force. Siplast-Icopal reserves the right to modify its products and their installation instructions, depending on the development of knowledge and techniques

