

**Waterproofing of water reservoirs and tanks on masonry substrates**  
**Liquid Applied Waterproofing (LAW):**  
**PARATHANE-2C TWP**

Substrate & Use of roof	Finishing	Standard warm roof /inverted roof
Masonry substrate <ul style="list-style-type: none"> <li>• Water reservoirs and tanks</li> <li>• Drinking water tanks</li> </ul>	Finish clear coat	Without insulation

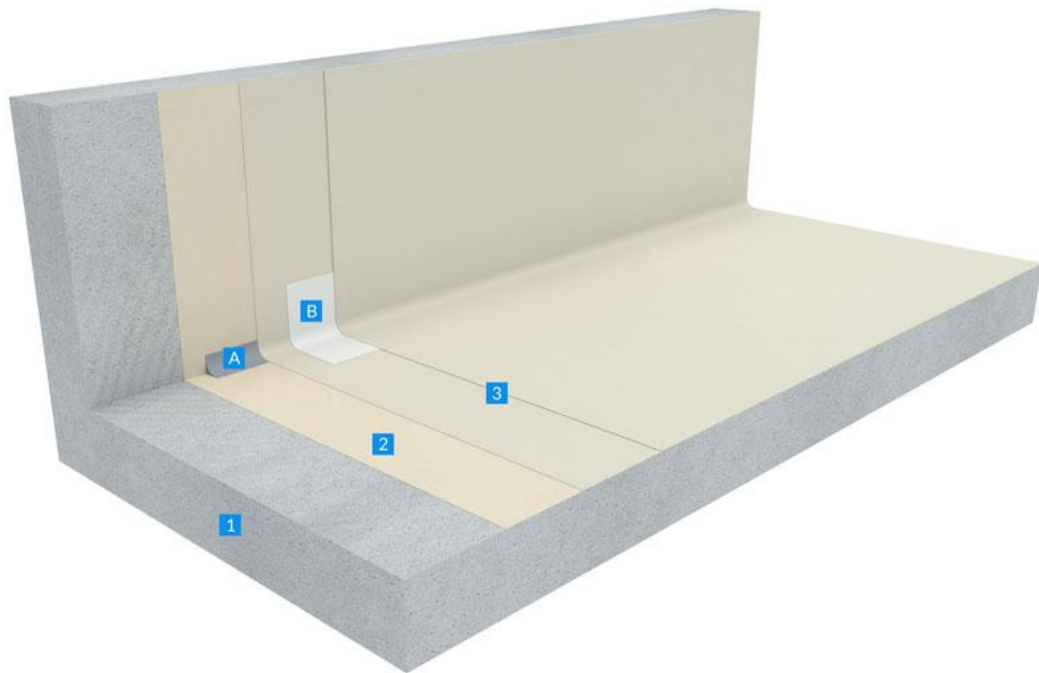

• **Substrate preparation:**

▪ **Surface:**

Substrate preparation (cleaning, abrasive polishing, sanding, grit blasting, etc.)  
 Prepare substrate surfaces thoroughly prior to application. Providing a smooth, even, sound, free of dust, grease and oil, foreign chemicals, curing compound, clean and dry substrate minimises the likelihood that underlying deficiencies will cause premature deterioration or even failure of the system.

*"The present document has been established on the base of the information provided and is purely indicative and non exhaustive. It cannot be substituted to recommendation and/or specifications made by professionals such as project manager, designing/engineering consultant, architect, and advisors. BMI cannot be liable in this regard. You must strictly ensure that the technical solution fits your project and has been validated by professionals and comply with any applicable regulations. You will find some technical documentation on our website: [www.bmigroup.com/international](http://www.bmigroup.com/international)"*

Elimination of all non-adherent and/or powdery parts (generally by mechanical abrasive polishing followed by careful vacuuming, and, if necessary, by grit blasting, chemical stripping, high pressure cleaning).

Making sure the substrate is dry when the Liquid Waterproofing System is applied.

Concrete:

Masonry bearing elements and substrates in compliance with local technical standards. (reinforced concrete, slabs, bonding screeds, etc.)

Are not accepted: slope screeds of lightweight concrete.

- **Primer:**

**PARATHANE Epoxy Primer:** Solvent-free, two-component water-based epoxy primer for coating the surface and ensuring surface adhesion for indoor and outdoor applications. 2 components to be mixed before application (A: epoxy resin and B: amine as hardener). Applied in 1 coat (350g/m<sup>2</sup>) or 2 coats (2x350g/m<sup>2</sup>) layers depending on the substrate's porosity. The primer is to be laid with the aid of rollers, rubber spreaders, toothed spreaders, brushes or by airless spray.

- **Upstands/Parapets**

**PARATHANE Epoxy Primer:** as above mentioned.

**PARATHANE Mastic chamfer:** one component polyurethane sealant. Use a flashing element sealant for details, angles and cracks by extrusion with a hand or pneumatic gun.

**PARATHANE-2C TWP Coating:** as mentioned hereafter

**PARATHANE Mat:** Polyamide fabric (Nylon jersey) for reinforcement of all details as angles, cracks and gaps. Upstand angle: on monolithic horizontal and vertical substrates (example: reinforced concrete), Parathane Mat is optional.

- **Waterproofing**

**PARATHANE-2C TWP** is a two-component, solvent-free, thixotropic coating, based on high quality elastomeric polyurethane resins. To be applied at 1.4 kg/m<sup>2</sup>, thickness > 1.2mm, in 2 coats minimum. The PARATHANE-2C TWP has been certified for use in potable water tanks (more details available on request from our technical department).

The PARATHANE-2C TWP is to be laid according to the desired thickness per coat, with the aid of the following tools: rollers, rubber spreaders, toothed spreaders, brushes or by airless spray.

There is a minimum waiting period of 28 days succeeding the application of Parathane 2C TWP for drinking water storage units.

*"The present document has been established on the base of the information provided and is purely indicative and non exhaustive. It cannot be substituted to recommendation and/or specifications made by professionals such as project manager, designing/engineering consultant, architect, and advisors. BMI cannot be liable in this regard. You must strictly ensure that the technical solution fits your project and has been validated by professionals and comply with any applicable regulations. You will find some technical documentation on our website: [www.bmigroup.com/international](http://www.bmigroup.com/international)"*